

# GUARDIAN AIR HOME

A BEYOND BY AERUS TECHNOLOGY

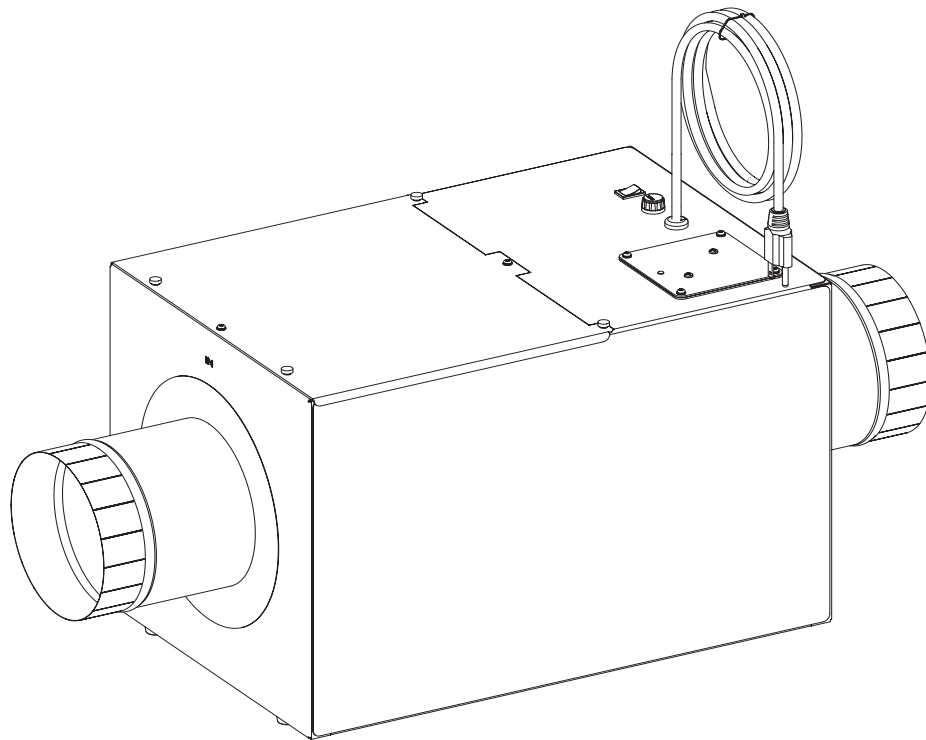

## AIR PURIFICATION SYSTEM

READ MANUAL CAREFULLY FOR PROPER USE AND OPERATION.



2017 Space Technology  
Hall of Fame Inductee

# GENERAL INFORMATION

## PRODUCT OVERVIEW

Congratulations! You will quickly realize that you have purchased a very effective air cleaning system. The Guardian Air Home incorporates an exclusive HEPA (High Efficiency Particulate Air) technology and Pre-Filter, along with our proprietary, ActivePure® Certified Space Technology.

Your Guardian Air Home comes with a 5 year limited warranty. With proper attention to its care and maintenance, you will receive optimum performance.

If your indoor air has abnormally high concentrations of particulates, the life span of the filter media may be shortened. Excessive particulates in the air will reduce the expected life of the HEPA Filter. Under normal conditions, the Pre-Filter can last up to one (1) year and the HEPA Filter with carbon can last up to two (2) years.

Air flow through the HEPA Filter will decrease over time, as dust builds up on the filter. If the air flow through your unit is noticeably reduced, inspect the Pre-Filter and HEPA Filter to determine if they should be replaced. Replacement of the Pre-Filter every twelve (12) months will help extend the lives of the HEPA Filter, which should be replaced, at least every two (2) years.

Please contact your Beyond by Aerus representative or Customer Service regarding replacement of filter, warranty information, or if you have any questions or concerns about the performance of your Guardian Air Home.

**NOTE:** This filtration system is an additional filter, and does NOT replace the existing air handler / furnace system filter.

## CONTENTS

General Information . . . . .	2
Important Safety Instructions . . . . .	3
Physical Dimensions and Features . . . . .	4
Operation . . . . .	5
Filter Change Instructions . . . . .	6
Changing the ActivePure® Cell . . . . .	7-8
U/V Lamp Indicator . . . . .	8
Maintenance . . . . .	9
Replacement Parts . . . . .	9
Service . . . . .	9
Warranty Information . . . . .	10

## SPECIFICATIONS

- Technology:**
- ActivePure®
- Electrical:**
- Supply Voltage: 120 VAC
  - Power Consumption: 1.45 Amps ; 96 Watts
- Mechanical:**
- Air Flow: 300 CFM
- System HEPA Filter Efficiency:**
- 99.97% @ 0.3 micron particles
- Dimensions:**
- 13.5" W x 13.5" H x 19.5" D (34 cm x 34 cm x 50 cm)
- Air Intake Collar:**
- 6" round
- Air Outtake Collar:**
- 6" round
- Weight**
- 14.35 lbs. (6.5 kg)
- Operating Temp:**
- (Return Air) 30° F to 95° F (-1 C to 35 C)
- Coverage:**
- Up to 3,000 sq. ft.
- Warranty:**
- Limited 5 Year Warranty
- Beyond By Aerus reserves the right to change or modify any specification without notice.

## FILL IN AND SAVE

Locate the serial number of your new Beyond Guardian Air Home and write it here. Retain it for future reference.

Model No. \_\_\_\_\_

Serial No. \_\_\_\_\_

Date of Purchase \_\_\_\_\_

Beyond by Aerus Distributor \_\_\_\_\_

Distributor's Office Phone No. \_\_\_\_\_

Distributor's Office Address \_\_\_\_\_

**If you have any questions regarding the use of this or any Beyond by Aerus product, please call toll-free: 800.572.0502.**

# IMPORTANT SAFETY INSTRUCTIONS



- WARNING:**
- Risk of property damage, injury or death
  - Installation, adjustments, alterations, and service must be performed by a qualified licensed HVAC service technician
  - Risk of Carbon Monoxide Poisoning
  - Do not operate equipment without filter access panel in place; operation of this equipment without all access panels and ducting in place may cause gas fumes from the heating system to be drawn into occupied spaces
  - To prevent damage to the unit, operating environment temperature must never exceed 130° F (54° C)
  - This unit must be installed by a licensed HVAC contractor; failure to do so will void warranty of the product
  - This unit must never be used with an extension cord



- WARNING:**
- Do not connect this unit to any voltage source other than what is stated on the rating plate
  - Electrical Shock Hazard
  - Can cause injury or death
  - Disconnect all electrical power supplies before servicing
  - Do not operate equipment without access panels in place
  - When using an electrical appliance, basic precautions should always be taken



- WARNING:** UV Light in operation. Disconnect unit from power supply before servicing. Failure to follow warnings may result in severe eye damage and electrical shock.



- WARNING:** Location for Protective Earth Line



- CAUTION:**
- This unit shall not be installed behind a suspended floor/ceiling or a structural wall, ceiling, floor, or window
  - Do not install in a cooking area or connect to any cooking appliance
  - This unit shall be installed a minimum of one meter from any accessible opening of the duct

## To reduce risk of fire, electrical shock, or injury to persons, observe the following

- Disconnect power before using
- Use only as described in this manual
- Do not attempt to repair or adjust any of the electrical or mechanical functions; contact Customer Service at 1-800-572-0502 for service information
- Do not use filters other than authorized Guardian Air Home filters
- To reduce risk of electric shock, do not use outdoors or on wet surfaces; for household use
- Do not allow to be used as a toy; do not allow to be operated by or around children
- Do not use with damaged cord or plug; if appliance is not working as it should, has been dropped, damaged, left outdoors, or dropped into water, contact Customer Service or your nearest authorized representative for assistance
- Do not pull or carry by cord, use cord as a handle, or pull cord around sharp edges or corners; keep cord away from heated surfaces; do not allow unit to sit on cord
- Do not unplug by pulling on cord; to unplug, grasp the plug, not the cord
- Do not handle plug or appliance with wet hands
- Do not allow foreign objects to enter the ventilation or exhaust openings
- Keep hair, loose clothing, fingers, and all parts of body away from openings and moving parts
- Turn off all controls before unplugging
- To avoid electric shock and fire hazards, plug directly into an appropriate electrical outlet (see voltage on unit); never use with an extension cord or power strip
- To reduce the risk of electrical shock, this appliance has a grounded plug (with a third prong). This plug will fit in a grounded outlet only one way; if it does not fit, contact a qualified electrician to install the proper outlet; do not change the plug in any way; do not use adapters

**SAVE THESE INSTRUCTIONS**

# PHYSICAL DIMENSIONS AND FEATURES

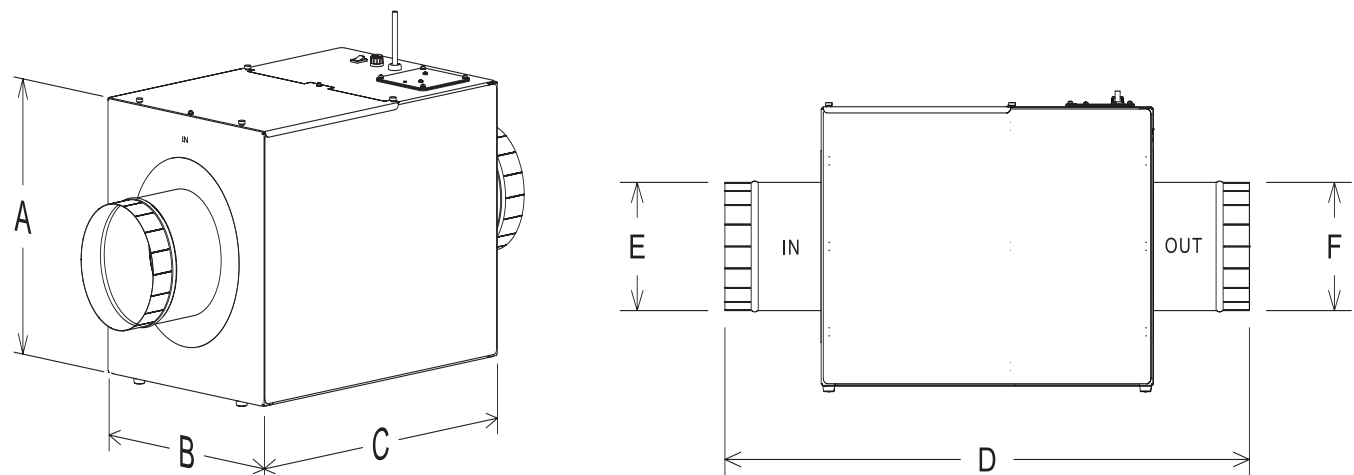

MODEL Guardian Air Home	A	B	C	D	E	F
Dimensions in inches	13.50"	13.50"	19.50"	31.00"	6.00"	6.00"
Dimensions in millimeters	343mm	343mm	495mm	788mm	152mm	152mm

## MEDIA FILTERS

Media filters strain particulates from the air. The filter media needs to have tiny holes to allow air to pass through, but not particulates. Filter types vary for all sorts of purposes. The most effective and proven filter media is HEPA. HEPA Filter media is 99.97% efficient at capturing particles which are 0.3 micron in size or larger.

## CARBON

Carbon is used to capture chemicals and odors, also referred to as VOCs. Chemicals and odors cannot be captured with media only filters. Activated carbon collects chemicals and odors in a process called absorption.

## THE 4 STAGE FILTRATION PROCESS

The 4 stage filtration process is used to create a very effective filtration system.

**Stage 1: Pre-Filter** - The Pre-Filter removes larger particulates from the air, thus prolonging the life of the HEPA Filter.

**Stage 2: Carbon** - The carbon layer contains activated carbon for removing chemicals and odors from the air.

**Stage 3: HEPA** - The HEPA Filter removes 99.97% of particulates 0.3 micron and larger.

**Stage 4: ActivePure** - ActivePure Technology sends friendly oxidizers into the room to continuously purify the air and deactivate contaminants on surfaces.

**NOTE:** Industry experience indicates that one (1) air change per hour generally provides adequate air cleaning. Actual results will depend on multiple factors such as outdoor particulate levels, infiltration rate, indoor activities etc.

Generally speaking, the more air changes per hour provided, the more effective a HEPA system will be.

# OPERATION



**WARNING:** This equipment should be inspected frequently and collected dirt removed from it regularly to prevent excessive accumulation that may result in flashover or a risk of fire. The unit must be turned off during service / maintenance or when filters are being changed.



**CAUTION:** It is recommended that gloves and a dust mask be worn during filter replacement.

Our filters are sealed in protective poly bags to ensure they are fresh and new when ready for use. Be sure to open each filter bag and discard the plastic coverings prior to installation. Do not operate the Guardian Air Home without removing the filters from their poly bags.

1. Make sure that the Guardian Air Home unit is positioned so that a connection can be made into a continuously powered, grounded outlet (120VAC, 60Hz) without the use of an extension cord.
2. For optimum performance, the Guardian Air Home system is designed to run continuously.
3. Turn the unit on by pressing the power switch to the 'I' position.
4. To turn the unit off, press the power switch to the 'O' position.

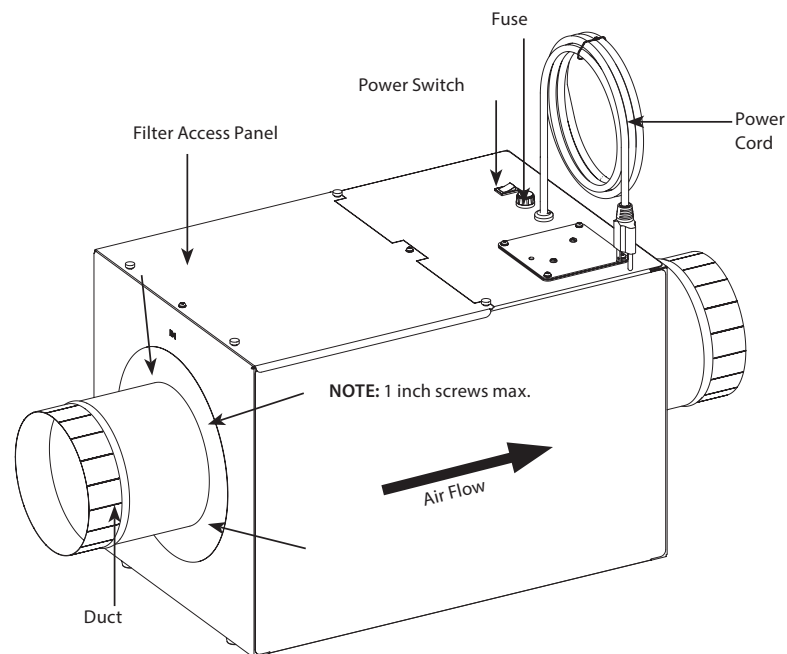

## TYPES OF INSTALLATIONS

ATTIC

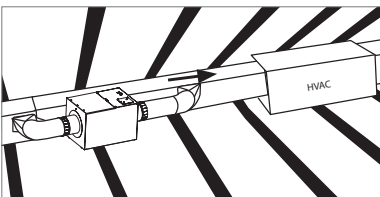

BASEMENT

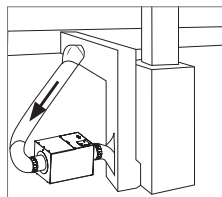

ROOM TO ROOM

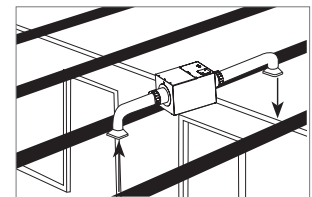

**NOTE:** It is highly recommended that the Guardian Air Home be installed on the cold-air side of duct systems.

# FILTER CHANGE INSTRUCTIONS



**WARNING:** This equipment should be inspected frequently and collected dirt removed from it regularly to prevent excessive accumulation that may result in flashover or a risk of fire. The unit must be turned off during service / maintenance or when filters are being changed.



**CAUTION:** It is recommended that gloves and a dust mask be worn during filter replacement.

Gloves and a filtered dust mask are recommended during filter replacement to avoid breathing particulates (dust, mold, pollen, etc.) captured on the filter that become airborne during the filter(s) change out.

The old filters should be wrapped and sealed in plastic bags immediately upon removal from the unit to avoid distributing particles throughout the house during the process of disposal.

## ACCESSING THE FILTERS

1. Turn the power switch to the off 'O' position before opening the access panel.
2. Remove the two (2) screws securing the filter access panel, located at the top center of the access panel. A Phillips head screwdriver will be required.
3. Remove the four (4) thumbscrew knobs securing the access panel, located at the top left, top right, and across the bottom of the access panel.
4. Lift the filter access panel off.

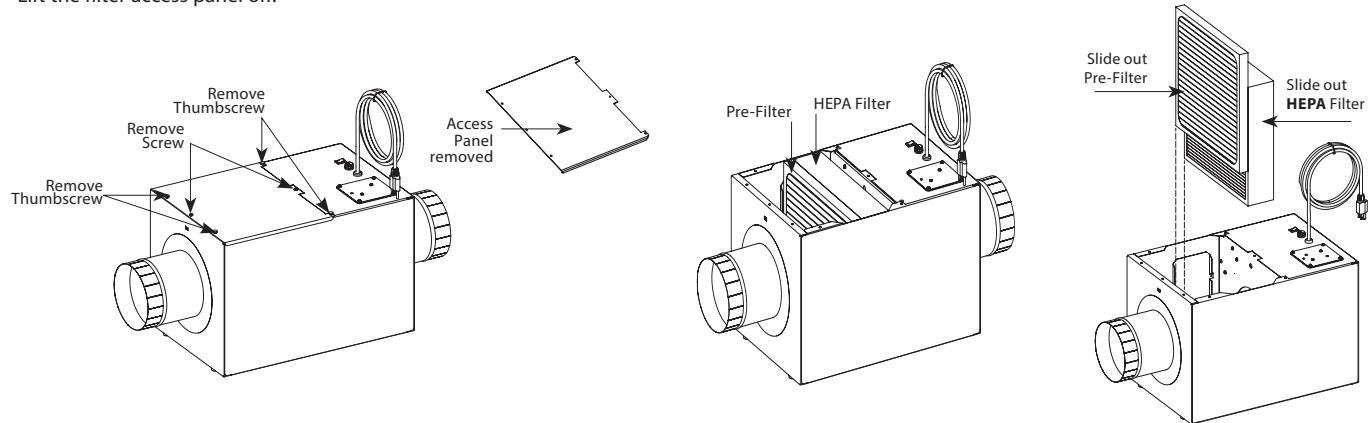

**NOTE:** Our filters are sealed in protective poly bags to ensure they are fresh and new when ready for use. Be sure to open each filter bag and discard the plastic coverings prior to installation. Do not operate the Guardian Air Home without removing the filters from their poly bags.

**NOTE:** See "Accessing the Filters" on page 5 before beginning.

## PRE-FILTER REPLACEMENT (AT LEAST EVERY 12 MONTHS)

1. Slide the Pre-Filter out of the filter slot.
2. Slide the new Pre-Filter into the filter slot. Make sure it is pushed in fully.
3. Close the access panel by placing it back and pushing the sides over the unit walls. The access panel should have a snug fit onto the unit. Re-install the screw and the thumbscrew knobs to secure the hinged panel back in place. Thumbscrew knobs should be a snug and hand-tight fit, do not over tighten.
4. Turn power switch to the on 'I' position.
5. Place old Pre-Filter in a plastic bag for disposal.

## HEPA FILTER MAINTENANCE (EACH TIME YOU REPLACE THE PRE-FILTER)

1. When changing the Pre-Filter, the HEPA Filter below it should be vacuumed off.
2. Slide the HEPA Filter out of the bottom filter slot and vacuum the front (carbon side) surface of the filters. Doing this will prolong the life of the filter.
3. After vacuuming the HEPA Filter, slide it back inside the lower filter slot. Make sure it is fully inserted.

## REPLACING THE HEPA FILTER (AT LEAST EVERY 24 MONTHS)

1. Slide the HEPA Filter out of the bottom filter slot.
2. Slide the new filter into the filter slot, carbon side out (facing Pre-Filter). Make sure it is pushed in fully.
3. Close the access panel and re-install the screw and thumbscrew knobs to secure the panel back into place. Thumbscrew knobs should be a snug and hand-tight fit. Do not over tighten.
4. Turn power switch to the on 'I' position.
5. Place old filter in a plastic bag for disposal.

**NOTE:** Proper care and maintenance of your Guardian Air Home will ensure years of service.

# CHANGING THE ACTIVEPURE® CELL



**WARNING:** Disconnect power at the breaker or fuse panel before servicing unit. Always follow OSHA lockout procedures to prevent accidental exposure to electrical energy.



**WARNING:** UV Light in operation. Disconnect unit from power cord before servicing. Failure to follow warnings may result in severe eye damage.

1. Disconnect (unplug) power cord from unit.

**NOTE:** Always follow OSHA electrical lockout safety requirements to prevent accidental release of energy during service or maintenance activities.

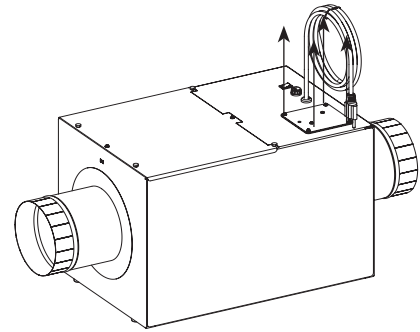

2. Remove the 4 screws.



3. Remove the ActivePure® Cell and base plate from the unit.

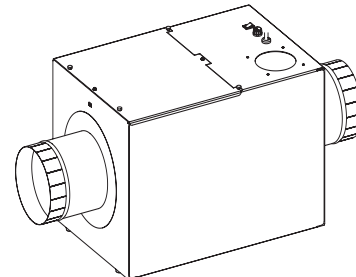

4. Remove the two screws holding the ActivePure® Cell and base plate.

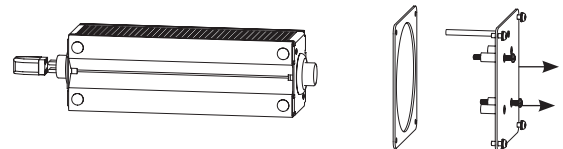

5. Separate the used ActivePure® Cell from the base unit and dispose of properly.

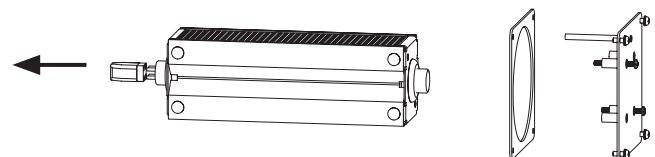

## CHANGING THE ACTIVEPURE® CELL (CONTINUED)

6. Plug the new ActivePure® Cell into the base unit.

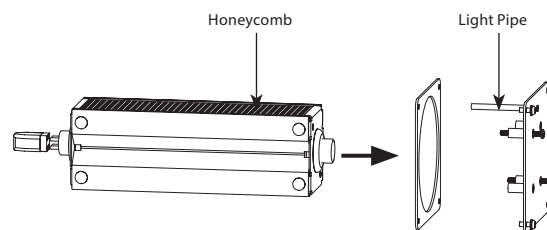

7. Secure with 2 screws.

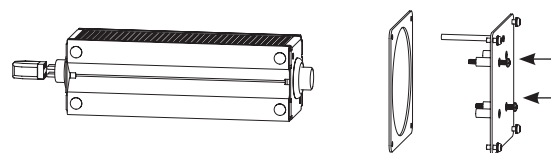

8. Insert the ActivePure® Cell and base plate into the unit.

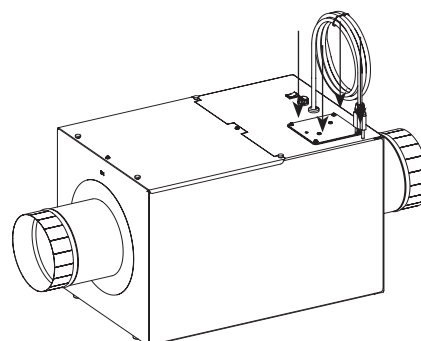

9. Secure with 4 screws.

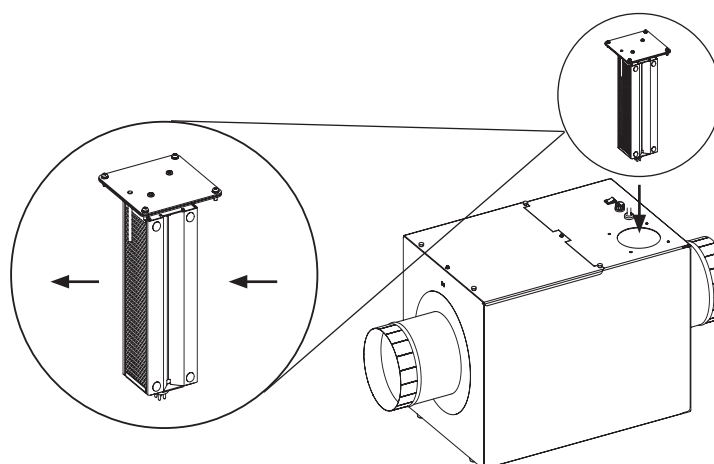

10. Reconnect power cord.

## UV LAMP INDICATOR

The UV bulb has an effective life of up to 2 years. The UV lamp operation indicator on the face of the unit will glow when the UV lamp is in use. If the indicator does not glow and the unit has power, the ActivePure. Cell should be replaced.

**NOTE:** For optimal performance, we recommend the replacement of the ActivePure. Cell every 2 years, even if the UV lamp appears to be operating normally.



# MAINTENANCE

**WARNING:**

- Electrical Shock Hazard
- Can cause injury or death
- Disconnect all electrical power supplies before servicing
- Do not operate equipment without access panels in place

**CAUTION:**

- Risk of Sharp Edges Hazard
- Equipment sharp edges can cause injuries
- Avoid grasping equipment edges without protective gloves
- It is recommended that gloves and a dust mask be worn during filter replacement

Proper care and maintenance of your Guardian Air Home will ensure years of service. The unit must be turned off during service / maintenance or when filters are being changed.

**NOTE:** It is recommended that gloves and a dust mask be worn during filter replacement.

**Pre-Filter** – Dust and other large particles will collect on the Pre-Filter over time. The color of the filter will change as particulates build up on the Pre-Filter. It is recommended to change the Pre-Filter at least every 12 months or as needed.

**HEPA Filters** – As the HEPA Filter captures particulates, it will darken over time. Vacuum the filter each time you change the Pre-Filter and replace the HEPA Filter every 2 years or as needed. The carbon layers in the HEPA Filter captures odors and gases. When this layer has reached its maximum absorbency, the filter will no longer work.

**ActivePure Cell** – For optimal performance, we recommend the replacement of the ActivePure® Cell every 2 years, even if the UV lamp appears to be operating normally.

**NOTE:** Failure to properly maintain your Guardian Air Home will decrease its efficiency and air flow. Filter life is based on average air content. Some filters may need to be changed more often due to higher amounts of dust, humidity, or chemicals found in your ambient air. Additionally, people who are more sensitive to these airborne contaminants may desire more frequent filter changes.

# REPLACEMENT PARTS

**WARNING:**

Use only replacement parts recommended by the manufacturer.

Replacement Parts (Qty.)	Part Number
HEPA Filter (1)	49901
Pre-Filter (1)	49900
ActivePure-Cell (ozone-free)	49902

Use this unit only in the manner intended by the manufacturer. If you have questions, contact Customer Service at 800.572.0502.

# SERVICE

For prompt service, call your Beyond by Aerus representative or Customer Service at 800.572.0502. Your authorized Beyond by Aerus representative offers you the best in service both during and after the warranty period, as well as genuine replacement parts and supplies.

Every effort is made to ensure that customers receive an up-to-date instruction manual on the use of our products; however, from time to time, modifications to our products without notice may make the information contained herein subject to alteration.

# WARRANTY INFORMATION

---

## LIMITED 5 YEAR WARRANTY

Customer should not repack and ship the Guardian Air Home unit due to possibility of irreparable damage. For warranty service, please contact your Beyond by Aerus Distributor or call Customer Service at 800.572.0502.

## WHAT IS COVERED BY THIS WARRANTY

We warrant the Guardian Air Home unit to the original Customer, subject to the conditions below, against defects in workmanship or material, provided that the products are returned to a service location within the following time periods:

- Guardian Air Home (excluding the ActivePure® Cell and Lamp) within five (5) years of date of purchase.
- ActivePure Cell and Lamp within two (2) years of date of purchase if the Guardian Air Home is connected to a power source where the ActivePure Cell is "ON" 100% of the time.

## INSTALLATION AND MAINTENANCE REQUIREMENTS

This warranty is expressly conditioned upon proper installation, operation, cleaning, and maintenance, all in accordance with the Owner's Manual including but not limited to, replacing your HEPA Filters with genuine Beyond by Aerus filters every 6 - 12 months, depending on usage, and replacing the ActivePure Cell with a genuine Beyond by Aerus part every 2 years (proof of change may be required). Failure to meet any of these requirements will void this warranty. Servicing of your Guardian Air Home by parties other than an authorized Beyond by Aerus location and/or using parts other than genuine Beyond by Aerus parts will also void this warranty.

## HOW TO OBTAIN WARRANTY SERVICE

Customer must contact their Beyond by Aerus Distributor and provide their proof of purchase within the above time periods. Beyond by Aerus will repair or replace and return the product, without charge and within a reasonable period of time, subject to the conditions herein, if its examination shall disclose any part to be defective in workmanship or material. If we, in our discretion, are unable to repair the product after a reasonable number of attempts, we will provide either a refund of the purchase price or a replacement unit, at the company's option. We reserve the right to inspect and/or require confirmation of installation method.

## WHAT IS NOT COVERED BY THIS WARRANTY

This product is intended for household use. Ordinary wear and tear shall not be considered a defect in workmanship or material. These warranties do not apply for loss or damage caused by accident, fire, abuse, misuse, improper installation, leaking, modification, misapplication, or by any repairs other than those provided by our authorized Service Center. Consumable items, such as Pre-Filter and HEPA Filter are not covered by this warranty. This warranty is non-transferable.

## MISSING SERIAL NUMBERS AND UNAUTHORIZED CHANNELS

If a valid serial number is missing from the product, the warranty will be voided. Beyond by Aerus products are for sale through authorized Distributors only. Warranties are voided if a product is purchased through unauthorized channels; this includes company sponsored or independent websites that are not authorized to use Beyond by Aerus' trademarked names, images and logos as well as Internet auction sites (e.g eBay and craigslist). The only approved company sponsored or independent internet sites for Beyond by Aerus products are [www.beyondbyaerus.com](http://www.beyondbyaerus.com) and [www.beyondforhome.com](http://www.beyondforhome.com). To confirm warranty coverage prior to purchasing a product, contact Beyond by Aerus at 800.572.0502 with the serial number located on the back of the unit.

## EXCLUSION OF OTHER WARRANTIES AND CONDITIONS

EXCEPT AS PROVIDED HEREIN, WE MAKE NO REPRESENTATION OR WARRANTY OF ANY KIND. ALL OTHER WARRANTIES OF ANY KIND, EXPRESS OR IMPLIED, ARE HEREBY EXPRESSLY DISCLAIMED, INCLUDING ANY IMPLIED WARRANTY OF MERCHANTABILITY OR FITNESS FOR A PARTICULAR PURPOSE.

## LIMITATION OF LIABILITY FOR SPECIAL, INCIDENTAL, OR CONSEQUENTIAL DAMAGES

WE SHALL NOT IN ANY CASE BE LIABLE FOR SPECIAL, INCIDENTAL OR CONSEQUENTIAL DAMAGES ARISING FROM BREACH OF EXPRESS OR IMPLIED WARRANTIES, CONDITIONS, GUARANTEES OR REPRESENTATIONS, BREACH OF CONTRACT, NEGLIGENCE OR ANY OTHER LEGAL THEORY. Such excluded damages include, but are not limited to, loss of profits or revenue and loss of the use of the products, and any loss caused by leaks or other water damage.

## FOR U.S. APPLICATION ONLY

This warranty gives you specific legal rights, and you may also have other rights which vary from state to state. Some states do not allow limitations on warranties, or on remedies for breach. In such states, the above limitations may not apply to you.

## FOR CANADIAN APPLICATION ONLY

Exclusion of Subsequent Owners: Except as otherwise required by applicable legislation, this warranty is not transferable. This warranty gives you specific legal rights and you may also have other rights which vary from province to province. Some provinces and territories do not allow limitations on warranties, or on remedies for breach. In such provinces or territories, the above limitations may not apply to you. If any provision of this warranty or part thereof is held by a court of competent jurisdiction to be invalid, illegal or unenforceable, the validity, legality and enforceability of the remaining provisions or parts thereof will not in any way be affected or impaired within the jurisdiction of that court. This entire warranty shall continue to be valid, legal and enforceable in any jurisdiction where a similar determination has not been made.

This warranty is provided by:

Aerus, LLC  
300 East Valley Drive,  
Bristol, VA 24201

## SERVICE

Every effort is made to ensure customers receive an up-to-date instructions manual on the use of our products; however, from time to time, modifications to our products may without notice make the information contained herein subject to alteration. For the latest information, please visit our website at [www.beyondbyaerus.com](http://www.beyondbyaerus.com) or call Customer Service at 800.572.0502.



This equipment has been tested and found to comply with the limits for a Class B digital device, pursuant of part 15 of the FCC Rules. These limits are designed to provide reasonable protection against harmful interference in a residential installation. This equipment generates, uses, and can radiate radio frequency energy, and if not installed and used in accordance with the instructions, may cause harmful interference to radio communications. However, there is no guarantee that interference will not occur in a particular installation. If this equipment does cause harmful interference to radio or television, which can be determined by turning the equipment off and on, the user is encouraged to try to correct the interference by one or more of the following measures:

Reorient or relocate the receiving antenna.

Increase the separation between the equipment and receiver.

Connect the equipment into an outlet on a circuit different from that to which the receiver is connected.

Consult the Independent HVAC Contractor or an experienced radio/TV technician for help.

## FCC Declaration of Conformity

---

**Name:** Guardian Air Home

**Model:** F193B

**Manufacturer:** Aerus LLC

This device complies with Part 15 of the FCC Rules.

## RESPONSIBLE PARTY

---

Aerus LLC  
300 East Valley Drive  
Bristol, VA 24201  
Ph: 800.572.0502

**Signature:** \_\_\_\_\_



**Printed Name:** Andrew Eide

**Title:** Vice President of Product Development  
and Manufacturing

**Date:** 10/08/2020

# BEYOND®

BY AERUS

**For information regarding the use of this product please call Customer Service.**

**800.572.0502**

**[www.beyondbyaerus.com](http://www.beyondbyaerus.com)**

Aerus LLC • 300 East Valley Drive • Bristol, VA 24201  
Aerus Canada, Inc. • 3480 Laird Road, Suite 2-5 • Mississauga, ON L5L 5Y4

©2020 Beyond by Aerus All rights reserved Beyond by Aerus® and Aerus® are trademarks owned by Aerus Concepts, L.P.